

# Pre-hopper

## The clean way of feeding products into continuous extrusion or mixing processes

It is important to reach continuous product flows in extrusion processes. Bulk goods often accumulate inside or get stuck to the walls of the hopper. The **ROWEFLEX®** Pre-hopper is the flexible solution for feeding products into various mixing processes. Because of its one of a kind design and construction, it fits into your system in the most flexible way and achieves a smooth product flow, even with problematic bulk goods. All discharge aids are placed on the outside of the hopper, which ensures no impairment of free product-flow and causes no pollution of the product.



Figure: Pre-Hopper with five inflows

### Advantages

#### of the **ROWEFLEX®** Pre-hopper:

- Flexible Transition between Dosing device and Extruder
- Adaption of in- and outflows to conditions on site
- Special sizes on request
- Various rubber materials for various applications
- FDA-compliant
- Available in ATEX version

### Applications

#### of the **ROWEFLEX®** Pre-hopper:

- Extrusion
- Food stuff industry
- Colour- and Masterbatchproduction
- Mixer supply

## ROWEFLEX® Pre-hopper

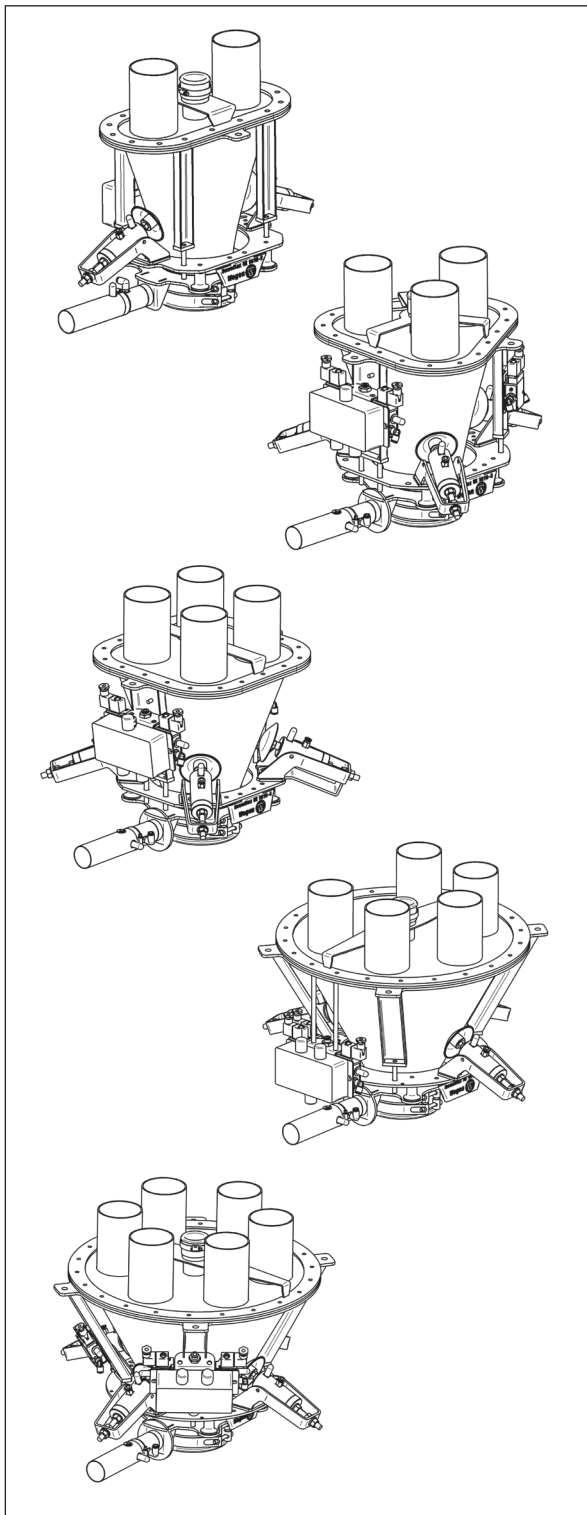

### Pre-hopper VE 1015-2-5886

|                     |                    |
|---------------------|--------------------|
| Material            | see chart below    |
| cross-section top   | oval, 330 x 160 mm |
| cross-section below | round, Ø 150 mm    |
| Total height        | 580 mm             |
| Weight              | 23 kg              |

### Pre-hopper VE 1015-3-6000

|                     |                              |
|---------------------|------------------------------|
| Material            | see chart below              |
| cross-section top   | triangle, 411 x 411 x 411 mm |
| cross-section below | round, Ø 150 mm              |
| Total height        | 580 mm                       |
| Weight              | 28 kg                        |

### Pre-hopper VE 1015-4-6026

|                     |                      |
|---------------------|----------------------|
| Material            | see chart below      |
| cross-section top   | square, 340 x 340 mm |
| cross-section below | round, Ø 150 mm      |
| Total height        | 580 mm               |
| Weight              | 31 kg                |

### Pre-hopper VE 1015-5-6091

|                     |                 |
|---------------------|-----------------|
| Material            | see chart below |
| cross-section top   | round, Ø 520 mm |
| cross-section below | round, Ø 150 mm |
| Total height        | 580 mm          |
| Weight              | 33 kg           |

### Pre-hopper VE 1015-6-6048

|                     |                 |
|---------------------|-----------------|
| Material            | see chart below |
| cross-section top   | round, Ø 520 mm |
| cross-section below | round, Ø 150 mm |
| Total height        | 580 mm          |
| Weight              | 35 kg           |

### Extract from material portfolio

| ROWEFLEX® Material | Description        | Colour | FDA-comp. | Electr. cond. |
|--------------------|--------------------|--------|-----------|---------------|
| NK                 | Natural rubber     | Beige  | -         | -             |
| NK                 | Natural rubber     | White  | +         | -             |
| PG                 | Natural rubber     | Grey   | -         | -             |
| CR                 | Chloroprene rubber | White  | +         | -             |
| CR                 | Chloroprene rubber | Black  | -         | +             |
| EP                 | EPDM rubber        | Black  | +         | +             |
| EP                 | EPDM rubber        | White  | +         | -             |
| NBR                | Nitrile rubber     | Black  | -         | +             |
| NBR                | Nitrile rubber     | White  | +         | -             |
| SI                 | Silicone rubber    | Light  | +         | -             |

We will gladly advise you with regard to the selection of the suitable ROWEFLEX® Material. Please do not hesitate to contact us regarding this.

The Pre-hopper comes pre-finished with the required number of vibration elements. We will gladly advise you in regard to special constructions with asymmetric inflows.